

UTL UMSR2 COUPLINGS

(Metalflex Coupling Antifly Design)

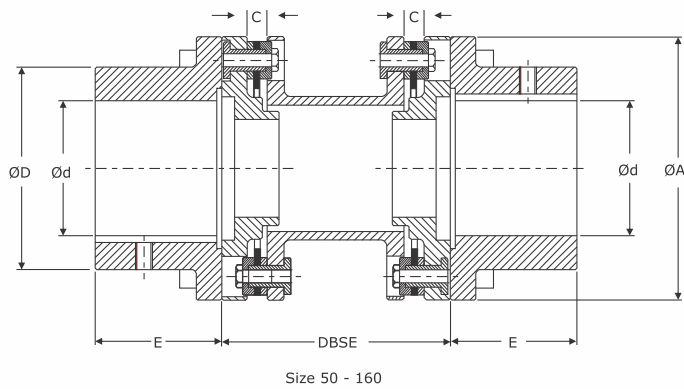
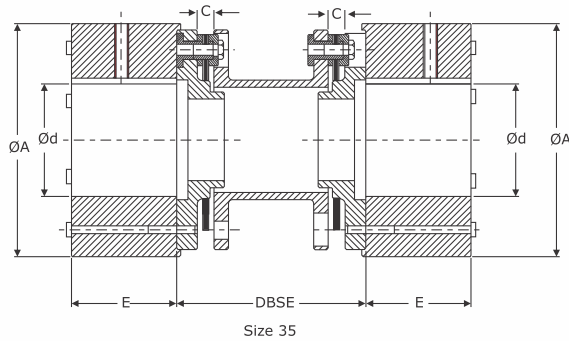
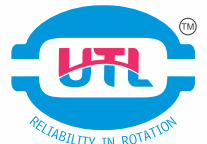

FEATURES

- Series for pump drives
- Coupling in accordance with API 610, API 671 optionally
- Available with large hub for bigger bore diameters
- Spacers are supplied assembled by the manufacturer
- Finish bore according to ISO fit H7, feather key according to DIN 6885 sheet 1 - JS9

Dimensions & Technical Data

Size	Torque Std Nm	Torque Max. Nm	Vibratory Torque kW	Dimensions are in mm									
				Max. Bore Ød	ØD	ØA	E	C	DBSE				
35	60	120	30	50	-	75	38.5	6	100	140	-	-	-
50	240	480	120	50	70	95	50	9	100	140	-	-	-
65	450	900	225	65	100	126	63	10	100	140	180	-	-
75	940	1880	470	75	105	138	62.5	10	100	140	180	-	-
85	1700	3400	850	85	120	156	72.5	12	-	140	180	200	250
110	2700	5400	1350	110	152	191	87	12	-	140	180	200	250
120	4500	9000	2250	120	165	213	102	12	-	-	180	200	250
140	9000	18000	4500	140	200	265	126	15	-	-	-	200	250
160	13000	26000	6500	160	230	305	145	15	-	-	-	-	250

• For non standard DBSE Please contact UTL

MATERIAL SPECIFICATIONS

Component	Size- 35 - 160	Material	Grade	Standard
Hub	Size- 35 - 160	Steel C 40	St	EN/DIN 10263-2
Spacer	Size- 35 - 160	Steel C 40	St	EN/DIN 10263-2
Disc Pack	Size- 35 - 160	Stainless Steel	SS	



• For temperature range of elastomers please see on page no. 34 - coupling selection