

UTL UFG COUPLINGS

(Full Gear Couplings)

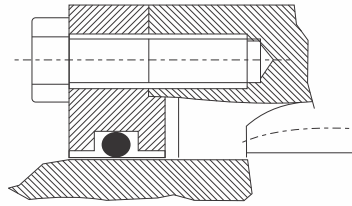

DETAIL 'X'
THIS COVER PLATE CONSTRUCTION FOR
SIZES UFG - 111 ONWARDS

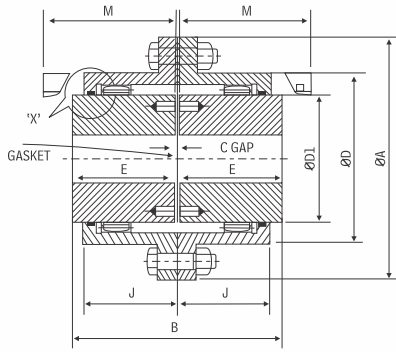

FEATURES

- Less Backlash
- Compact Assembly
- Larger Bore Capacities
- High Power To Weight Ratio
- Accommodates Angular, Parallel and Axial Misalignments
- Generally used up to 120° C. Can be used for higher temperatures by using proper grade of grease or oil
- Standard full flexible gear coupling TYPE UFG accommodates angular & parallel misalignments or a combination of both as well as axial misalignment (end float). Ideal for all horizontal, close coupled applications including fans, overhead cranes, conveyors, steel & paper mill equipments. One or both the hubs can be easily reversed for more than normal shaft separation applications.

Dimensions & Technical Data

Size	kW at 100 rpm	Rated Torque Nm	Max. rpm	Bore		Dimensions are in mm								Solid Hub	
				PB	Max.	ØA	E	ØD1	ØD	M	C	J	B	Wt. kg	M.I.(WR ²) kg-m ²
100	5.2	497	7600	10	35	120	45	50	75	55	3	39.5	93	4.2	0.0075
101	10.5	1002	6300	20	50	170	55	65	110	65	5	49	115	11	0.035
102	26.1	2492	5000	30	60	185	70	85	125	80	5	62	145	15	0.05
103	47	4486	4000	40	75	220	85	105	150	105	5	78	175	25	0.12
104	89	8495	3350	50	90	250	105	130	175	125	5	96	215	39	0.238
105	136	12982	2800	60	110	290	110	155	200	140	10	106	230	57	0.488
106	209	19950	2500	75	125	320	125	175	230	155	10	117	260	85	0.75
107	366	34936	2100	90	140	350	140	205	260	175	10	134	290	103	1.313
108	470	44864	1900	105	160	380	155	230	290	190	10	147	320	138	2.125
109	585	55841	1700	125	180	430	165	250	330	205	10	156	340	210	3.75
110	856	81709	1400	140	220	490	180	310	390	220	10	171	370	277	7.625
111	1146	109391	1250	160	260	545	200	350	445	240	10	192	410	550	14.5
112	1532	146236	1120	180	300	590	240	400	490	280	10	231	490	710	22.0
113	2084	198927	1000	200	330	680	260	440	555	310	15	242	535	980	34.5
114	2980	284455	900	220	370	730	280	500	610	330	15	266	575	1320	72.75
115	3620	345545	800	250	410	780	320	540	660	370	15	305	655	1700	88.25
116	6250	596591	710	300	455	900	350	625	755	423	20	335	720	2550	172.0
117	8890	848591	630	375	520	1000	400	720	855	490	20	386	820	3620	309.0
118	11770	1123500	560	450	610	1100	450	810	950	533	20	430	920	4860	491.0
119	15521	1481550	500	520	710	1250	485	910	1050	558	30	446	1000	6380	753.0

*Spacer Couplings also available on specific request.

MATERIAL SPECIFICATIONS

Hub	All Sizes	Forged Steel EN9	St	C-45
Sleeve	Sizes 100 - 106	EN9	St	EN / DN - 10236
Sleeve	Size 107 - 119	Cast Steel	St	-
O Ring	All Sizes	Synthetic Rubber	-	-
Gasket	All Sizes	Beta Flex	-	72 No
Hex Bolt	All Sizes	High Tensile	St	ISO 4014 : Gr 8.8



* For temperature range of elastomers please see on page no. 34 - coupling selection