

UTL UTEX COUPLINGS

(Curved Jaw with Spider)

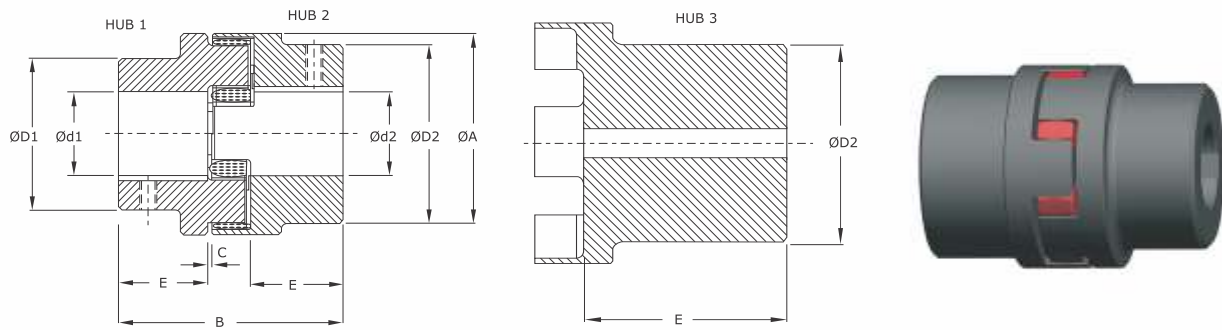

FEATURES

- Torsionally flexible, maintenance free
- Machined surfaces improve the dynamic properties
- Compact design

Dimensions & Technical Data

Size	Component	Rated Torque Nm		Max. speed rpm	Dimensions in mm								
		92° Shore A (Yellow Colour)	98° Shore A (Red Colour)		Min. bore	Max. bore		ø A	ø D1	ø D2	E	C	B
						ø d1	ø d2						
14	Hub 2	7.5	12.5	19000	6	16	30	30	11	1.5	35		
19	Hub 1	10	17	14000	6	19	40	32	25	2	66		
	Hub 2					24		41					
24	Hub 1	35	60	10600	9	24	56	40	30	2	78		
	Hub 2					28		56					
28	Hub 1	95	160	8500	10	28	66	48	35	2.5	90		
	Hub 2					38		66					
38	Hub 1	190	325	7100	12	40	80	66	45	3	114		
	Hub 2					48		78					
	Hub 3					70		164					
42	Hub 1	265	450	6000	14	45	95	75	50	3	126		
	Hub 2					55		94					
	Hub 3					75		176					
48	Hub 1	310	525	5600	15	52	105	85	56	3.5	140		
	Hub 2					62		104					
	Hub 3					80		188					
55	Hub 1	410	685	4750	20	60	120	98	65	4	160		
	Hub 2					74		118					
65	Hub 1	625	940	4250	22	70	135	115	75	4.5	185		
75	Hub 1	1280	1920	3520	30	80	160	135	85	5	210		
90	Hub 1	2400	3600	2800	40	97	200	160	100	5.5	245		

MATERIAL SPECIFICATIONS

Hub	Size-14-90	Steel	St	S 355 J2G3 (St 52.3)
Hub	Size-24-90	Cast Iron	CI	EN - GJL - 250 (GG 25)
Hub	Size-14-28	Aluminum	AL	BS 1490-LM 4
Spider 92° Shore A (Yellow Colour)	All Size	Polyurethane	PU	
Spider 98° Shore A (Red Colour)	All Size	Polyurethane	PU	



• For temperature range of elastomers please see on page no. 34 - coupling selection