

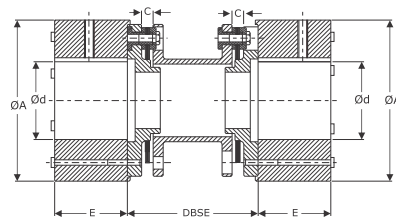

UTL FLEXIBLE COUPLINGS

**Utkarsh**<sup>®</sup>  
**FLEXIBLE COUPLINGS**  
*Revolutionizing Rotation*

**UTL UMSR2 COUPLINGS**  
(Metalflex Couplings Antify Design)



Size : 35

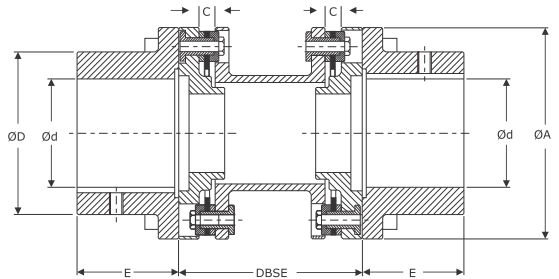

Size : 50-160

### FEATURES

- Series for pump drives
- Coupling in accordance with **API 610, API 671 optionally**
- Available with large hub for bigger bore diameters
- Spacers are supplied assembled by the manufacturer
- Finish bore according to ISO fit H7, feather key according to DIN 6885 sheet 1 - JS9

### DIMENSIONS & TECHNICAL DATA

Size	Rated Torque Nm	Max. Speed rpm	Dimensions are in mm										Wt in. Kg	Moment of inertia (kg.m <sup>2</sup> )
			Max. Bore Ød	ØD	ØA	E	C	DBSE						
35	130	22800	50	-	75	38.5	6	100	140	-	-	-	On request UTL will provide data.	On request UTL will provide data. According to spacer length.
50	270	17900	50	70	95	50	9	100	140	-	-	-		
65	550	13500	65	100	126	63	10	100	140	180	-	-		
75	1100	12200	75	105	138	62.5	10	100	140	180	-	-		
85	1900	10900	85	120	156	72.5	12	-	140	180	200	250		
110	3500	8900	110	152	191	87	12	-	140	180	200	250		
120	5750	8000	120	165	213	102	12	-	-	180	200	250		
140	10500	6300	140	200	265	126	15	-	-	-	200	250		
160	16000	5500	160	230	305	145	15	-	-	-	-	250		

• For non standard DBSE please contact UTL

### MATERIAL SPECIFICATIONS

Hub	Size - 35 - 160	Steel C 40	St	EN/DIN 10263 - 2
Spacer	Size - 35 - 160	Steel C 40	St	EN/DIN 10263 - 2
Disc Pack	Size - 35 - 160	Stainless Steel	SS	

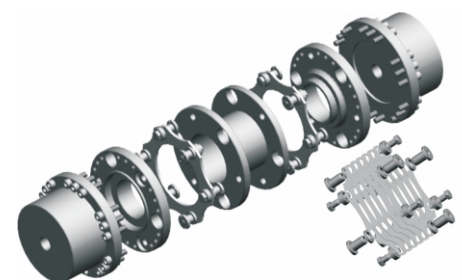

• For temperature range of elastomers please see on page no. 47 - coupling selection  
[www.utlcoupling.com](http://www.utlcoupling.com)