

FEATURES

- UFC couplings are essentially general purpose couplings with a flexible spider which can accommodate higher degree of misalignment.
- Parallel misalignment upto 0.5 mm
- Axial misalignment up to 1.7 mm
- The design of the UFC coupling has been optimised so that power capacities are balanced to the appropriate shaft diameters.
- Spider are unaffected by moisture, grease and oils-including non-aromatic and non-ketone solvents & temperatures within the range 40°C to + 100°C virtually eliminated and lubrication free.

DIMENSIONS & TECHNICAL DATA

Size	kW rating at 100 rpm	Type F & H								Type B								Weight in Kg	Moment of inertia (kg.m ²)		
		TLB Size	Min. Bore	Max. Bore	C	D	F	L	J*	Min. Bore	Max. Bore	C	D	F	L	A	B			E	G
70	0.33	1008	9	25	20.0	24	26.0	66.0	29	10	32	20	24	26.0	66.0	69	60	31	18.0	On request UTL will provide data.	On request UTL will provide data.
90	0.84	1108	9	28	19.5	24	31.5	70.5	29	10	35	26	30	30.5	82.5	85	70	32	22.5		
110	1.68	1210	11	32	18.5	27	46.0	83.0	38	10	55	37	45	45.0	119.0	112	100	45	29.0		
110A	1.68	1610	14	42	18.5	27	46.0	83.0	38	-	-	-	-	-	-	112	100	45	29.0		
130	3.30	1610	14	42	18.0	27	54.0	90.0	38	14	60	47	56	54.0	148.0	130	105	50	36.0		
150	6.28	2012	14	50	23.5	34	61.0	108.0	44	19	70	50	60	60.0	160.0	150	115	62	40.0		
180	9.95	2517	16	60	34.5	47	74.0	143.0	48	35	80	58	70	73.0	189.0	180	125	77	49.0		
230	20.90	3020	25	75	39.5	53	86.5	165.5	55	38	100	77	90	85.5	239.5	225	155	99	59.5		
280	33.00	3525	35	90	51.0	67	106.5	208.5	67	48	115	90	105	104.5	284.5	275	206	119	74.5		

* J - Wrench clearance to allow tightening and loosening the bush on the shaft

MATERIAL SPECIFICATIONS

Hub	70 - 280	Cast Iron	CI	DIN 1693 GG 25
Spider	80°	Synthetic Rubber	NBR	St. ASTM D 2000BG810

ALTERNATIVE SPIDERS

Execution in Hytrel, Polyurethane available on request.

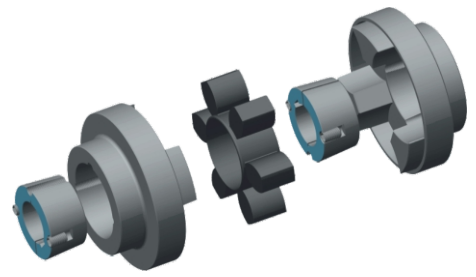

* For temperature range of elastomers please see on page no. 47 - coupling selection
www.utlcoupling.com